

CSO3050PE/S/P

CARACTERÍSTICAS

Elegant modern aesthetics

Features both plumbed and non-plumbed options

Sleek Full-color LCD Touchscreen

Save up to 50 personalized favorite recipe presets.

11 Cooking Modes

1750-watt recessed broil element

2.4 cubic-foot oven cavity

Three full-extension rack positions and one standard position

Large 40-fluid ounce water tank

La sonda de temperatura le alerta cuando su plato ha alcanzado la temperatura deseada

ACCESORIOS

Bandeja perforada 12 3/4" x 1 1/2" x 7"

Bandeja perforada 17 3/4" x 1 1/4" x 15"

Bandeja sólida 12 3/4" x 1 1/2" x 7"

Broiler Rack

Porcelain Steam Enameled Broil Pan

Solid Pan - 24 3/4" x 1 3/8" x 14 1/2"

Solución descalcificadora

Standard Oven Rack

Temperature Probe

Los electrodomésticos están disponibles por medio de un comerciante autorizado. Para información del comerciante local, visite subzero-wolf.com/locator.



ESPECIFICACIONES DEL PRODUCTO

| | |
|----------------------------------|----------------------------------|
| Modelo | CSO3050PE/S/P |
| Dimensiones | 29 7/8"W x 17 7/8"H x 22 1/2"D |
| Dimensiones Interiores del Horno | 17 1/2"W x 10 3/4"H x 15 1/8"D |
| Overall Capacity | 2.4 cu. ft. |
| Usable Capacity | 1.8 cu. ft. |
| Paso de Puertas | 14 3/16" |
| Peso | 91 lbs |
| Suministro Eléctrico | 240/208 Vca, 60 Hz |
| Servicio Eléctrico | circuito dedicado de 20 amperios |
| Longitud del Conducto | 4 Feet |

NOTE: Dimensions in parenthesis are in millimeters unless otherwise specified

DIMENSIONES

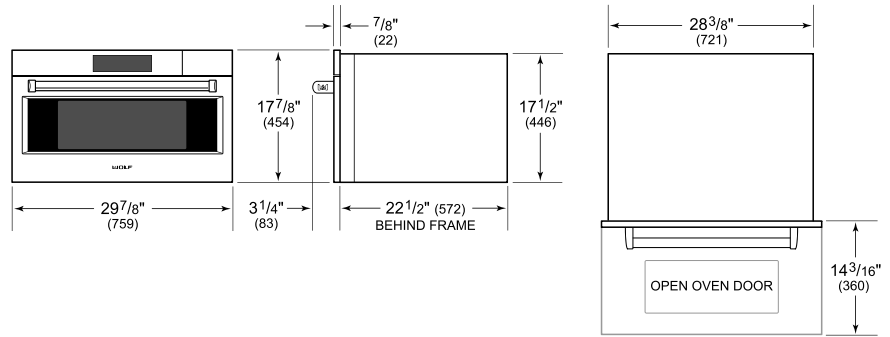

FLUSH INSTALACIÓN

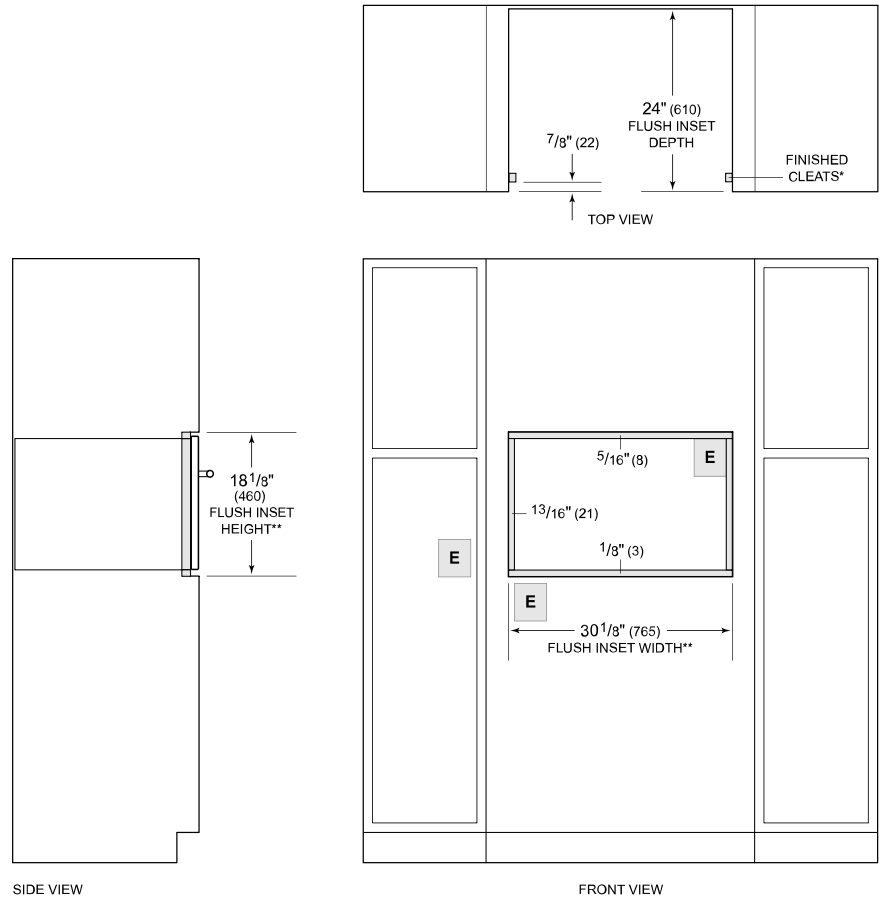

*Will be visible and should be finished to match cabinetry.

**Dimension provides minimum reveals.

NOTE: Location of electrical supply within opening may require additional cabinet depth.