

DEC2450FI



## CARACTERÍSTICAS

ClearSight™ LED lighting system fully illuminates the interior and reduces shadows

Sleek stainless accents trim the interior, matching the sophistication of the exterior

Easily customize settings with the tap of a finger via the conveniently accessible touch control panel

Night Mode optimizes the interior lighting based on the detected ambient light, reducing the brightness by 90% in dim environments

Position adjustable door shelves at various heights to accommodate assorted items

Fresh-tasting, filtered ice ready on-demand and activate Max Ice Mode to temporarily increase ice production

Locks in cold air with a magnetic door seal system

Wi-Fi enabled features provide remote access from your mobile device

Sub-Zero offers an industry-leading full two-year warranty on appliances, along with a full five-year sealed system warranty and a limited twelve-year sealed system warranty

Accepts custom panels for an integrated look within cabinetry or stainless-steel accessory panels and handles to match other Sub-Zero, Wolf, and Cove products

## ACCESORIOS

Carcasa lateral inoxidable

Filtro de agua 4204490

Reduced Toekick Divider

Stainless Steel Door Panel with Pro Handle and 4" Toe Kick - LH

Stainless Steel Door Panel with Pro Handle and 4" Toe Kick - RH

Stainless Steel Door Panel with Tubular Handle and 4" Toe Kick - LH

Stainless Steel Door Panel with Tubular Handle and 4" Toe Kick - RH

Dual Installation Kits

Stainless Steel Dual Installation Kickplates

Stainless Steel Pro and Tubular Handles

Los electrodomésticos están disponibles a través de un comerciante autorizado. Para información de comerciante local, visite [subzero-wolf.com/locator](http://subzero-wolf.com/locator).



## HANDLE ACCESSORIES

PRO



TUBULAR



## DETALLES DEL PRODUCTO

### CONGELADOR

- LED freezer lights
- 4 freezer shelves (3 adjustable; 1 stationary)
- 2 storage drawers with adjustable dividers
- 5 adjustable door bins
- Ice drawer with automatic ice maker

**ESPECIFICACIONES DEL PRODUCTO**

|                         |                                  |
|-------------------------|----------------------------------|
| Modelo                  | DEC2450FI                        |
| Dimensiones             | 24"W x 84"H x 24"D               |
| Paso de Puertas         | 22 1/2"                          |
| Peso                    | 365 lbs                          |
| Capacidad de Congelador | 12.4 cu. ft.                     |
| Suministro Eléctrico    | 115 Vca, 60 Hz                   |
| Servicio Eléctrico      | circuito dedicado de 15 amperios |
| Receptáculo             | 3-prong grounding-type           |

**ELÉCTRICO**

**PLOMERÍA**

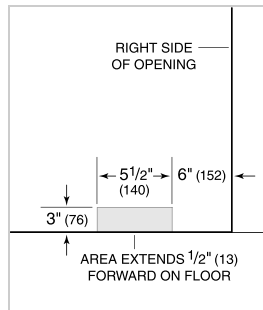
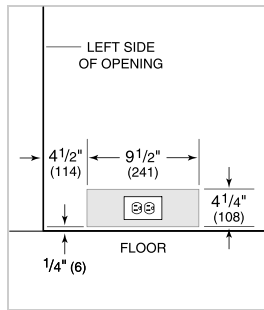

**ESPECIFICACIONES DEL PANEL** Para las especificaciones completas de los paneles incluyendo la anchura y altura, peso, requerimientos de espesor y detalles de compensación visite [subzero-wolf.com/integratedconfigurator](http://subzero-wolf.com/integratedconfigurator).

**NOTE:** Dimensions in parenthesis are in millimeters unless otherwise specified

**VISTA INTERIOR**

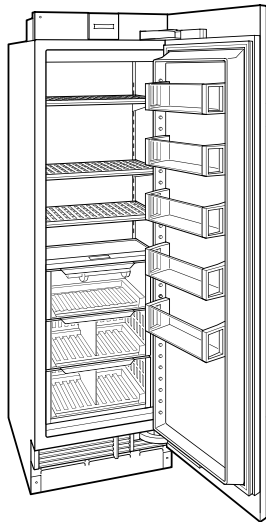

Esta ilustración es sólo para referencia y no debe representar el exterior del modelo especificado.

**DIMENSIONES**

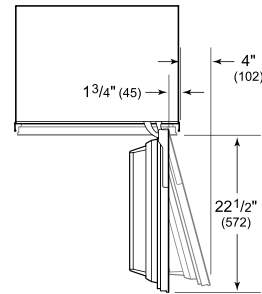
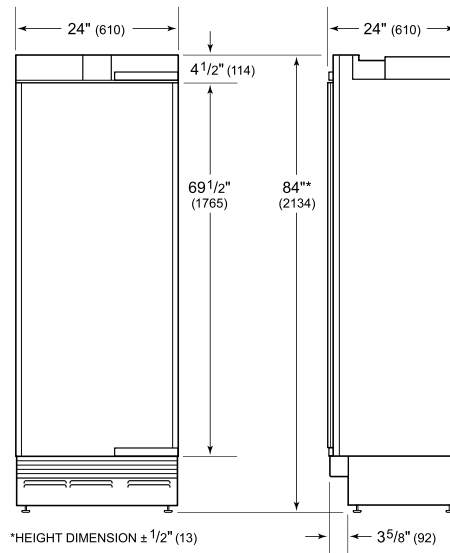

**STANDARD INSTALLATION**

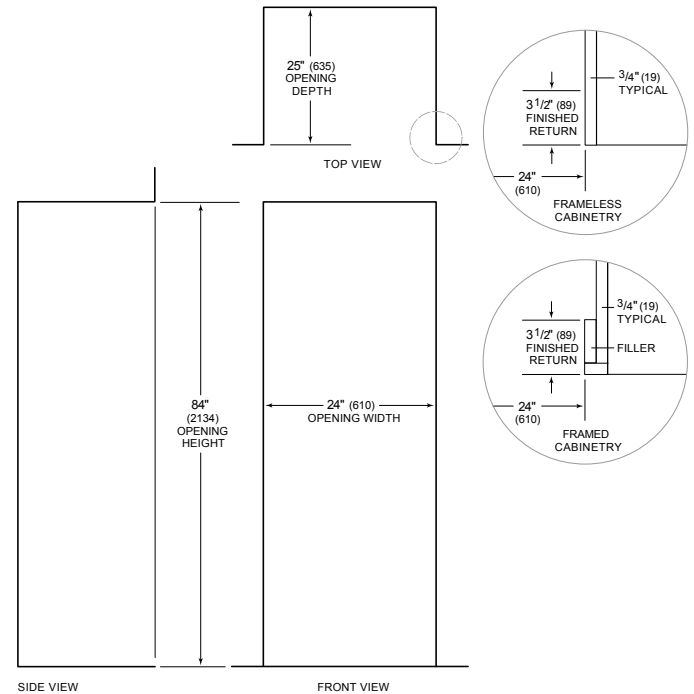

**NOTE:** 3 1/2" (89) finished returns will be visible and should be finished to match cabinetry