

DW2451/ADA



CARACTERÍSTICAS

Cove's new advanced wash system drives three powerful spray arms, 43 spray jets, and a fine-mesh filter that removes food and grease and circulates clean water

Every glass, dish, and utensil comes out spotless and dry thanks to the hot rinse and fan assist

Whisper-quiet operation means you can keep the conversation flowing while running a load of dishes

Quality and aesthetics meet in a striking stainless-steel interior with a clean, fastenerless design

12 wash cycles and 6 add-on options can be mixed and matched, allowing you to personalize cleaning to your needs

Highly adjustable offering infinite interior variations depending on your dishwashing needs; height-adjustable middle rack and fold-down tines accommodate large pots and tall items

Loading and unloading is easy with interior LED lights that aid in visibility

Stainless or panel-ready, in handle or handleless designs, complement any décor and coordinate perfectly with other Sub-Zero and Wolf appliances

Dishwasher disappears into the kitchen with hidden control panel and discreet status light

With our convenient Owner's App, you can remotely start or monitor a cycle, receive alerts when rinse aid is low—even set up auto-replenishment

El sistema de protección contra fugas de Cove ofrece tranquilidad en el raro caso de que se produzcan fugas. En caso de se produzca una fuga, el sensor de conductividad situado en la base de la unidad la detecta y detiene de manera automática el ciclo en curso.

ACCESORIOS

4" Stainless Kickplate - 60cm Opening

Pro Handle Kit

Tubular Handle Kit

Zócalo de acero inoxidable de 4" - Apertura de 24"

Kits de paneles de puerta de acero inoxidable de 24"

Kits de paneles de puerta de acero inoxidable de 60 cm

Los accesorios están disponibles a través de un distribuidor autorizado. Para obtener información sobre los distribuidores locales, visite subzero-wolf.com/locator.



HANDLE ACCESSORIES

PRO



TUBULAR



DETALLES DEL PRODUCTO

DISHWASHER

- 4 luces LED (2 laterales; 2 superiores)
- 43 surtidores en tres brazos rociadores
- Filtro de malla fina de cuatro etapas
- Barra ajustable para cristalería
- Estante para tazas ajustable
- Rejilla media de altura ajustable
- Rejilla inferior de fácil deslizamiento
- Rejilla superior para cubiertos
- Una cesta grande para cubiertos
- Dientes abatibles en las rejillas inferior y central

ESPECIFICACIONES DEL PRODUCTO

Modelo	DW2451/ADA
Dimensiones	23 5/8"W x 32 1/2"H x 23 1/4"D
Espacio de la puerta	25"
Nivel de sonido	41 dBA (Model and cycle/option dependent)
Suministro eléctrico	115 VAC, 60 Hz
Servicio eléctrico	15 amp dedicated circuit
Receptáculo	3-prong grounding-type
Longitud del cable	6'
Conexión de agua	5' braided tubing with 3/8" female compression fitting
Conexión de drenaje	5' (1.5 m) corrugated tubing
Presión de las tuberías	30–140 psi

INSTALACIÓN ELÉCTRICA PLOMERÍA

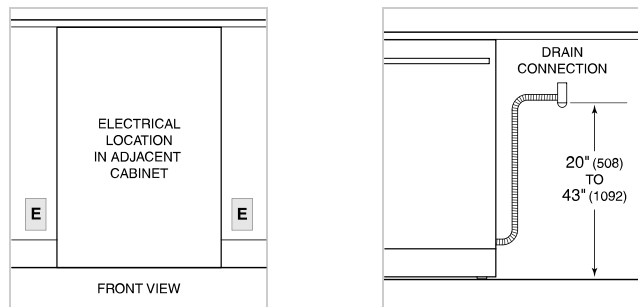

COVE OPENING WIDTH Cove dishwashers accommodate varying opening widths. A 23 5/8" (60 cm) width provides minimum reveals and is ideal for new construction. A 24" width is also common; however, reveals for a 24" opening will be larger than the reveals for a 23 5/8" opening unless the panel width is adjusted accordingly. 24" and 60 cm stainless steel panels are available and must be specified accordingly.

PANEL SPECIFICATIONS For complete panels specifications including width/height, weight requirements and thickness requirements visit subzero-wolf.com/reveal.

VISTA INTERIOR

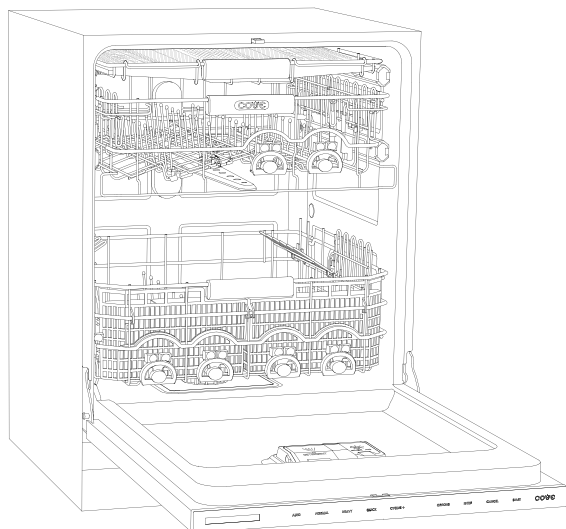

Esta ilustración es solo para referencia interior y puede no representar el exterior del modelo especificado.

DIMENSIONES

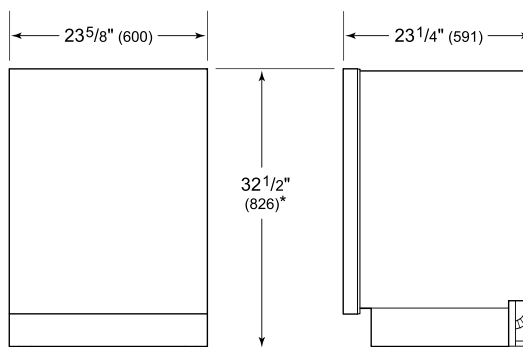

*31 7/8" (810) MIN TO 32 7/8" (835) MAX

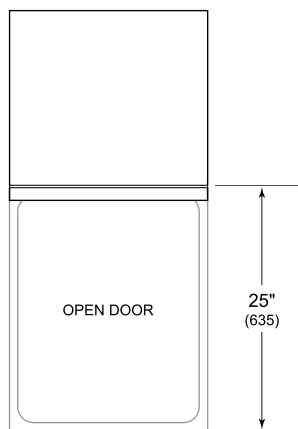

60 CM INSTALLATION

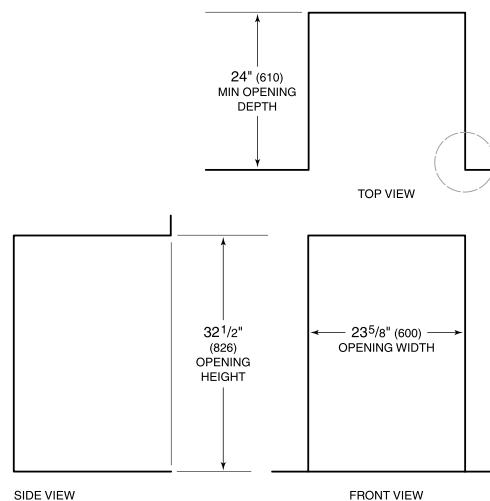

NOTE: 3 1/2" (89) finished returns will be visible and should be finished to match cabinetry.

